

## Demand Switch Installation

**To be installed by a Licensed Electrician and must conform to local electrical code**

### Parts Supplied



Automatic Demand Switch



Remote Control Demand Switch



Din Mounting Rail



Warning Stickers

### Assembled View



### Electrical Box

Supplied by your local electrician or hardware store

Preparing the switch for wiring by removing its protective covers

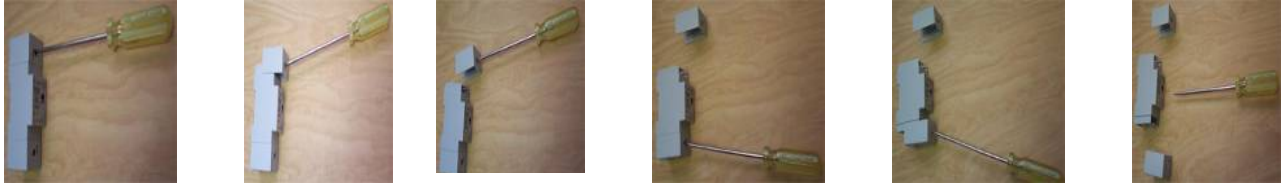

Attach the electrical box to the breaker panel and mount it onto the wall with 4 screws.



Attach the mounting rail to the electrical box with 2 screws.



Prepare the switch for mounting by **gently** removing the mounting rail spacer with a slot screw driver. The tab is spring loaded and will release the spacer when pressure is applied.



Attach the demand switch to the mounting rail with the help of a slot screw driver. The tab is spring loaded and will open when **gentle** pressure is applied.



### Automatic Demand Switch Installation

Connect pole #1 of the Automatic Demand Switch to the breaker of the controlled branch circuit (Hot Input). Connect pole #4 or #5 of the Automatic Demand Switch to the controlled branch circuit (Hot Output). Connect the neutral to pole #9 of the Demand Switch.

**Note: The Demand Switch simply interrupts the hot wire and switches it off and on. The switching is load dependent.**

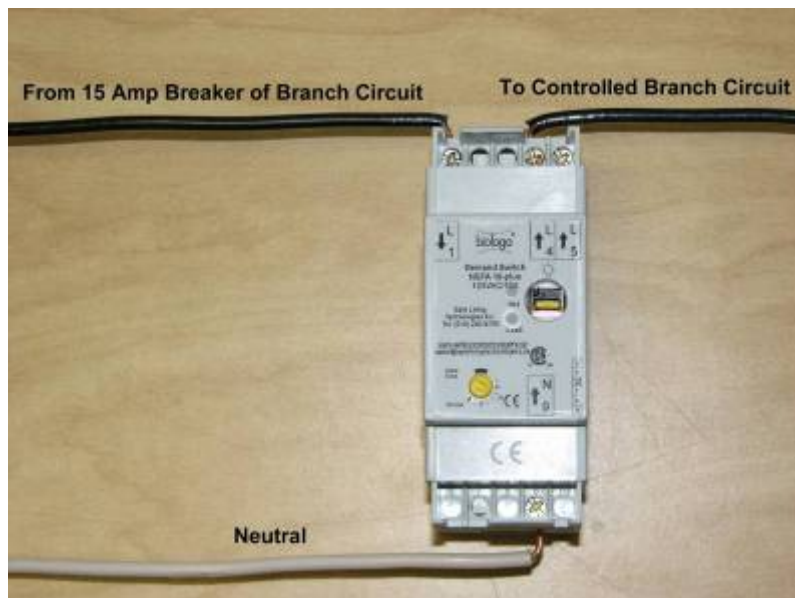

## Remote Control Demand Switch Installation

Installing the Remote control Demand Switch is similar to the Installation of the Automatic Demand Switch. Connect pole #1 of the Remote Control Demand Switch to the breaker of the controlled branch circuit (Hot Input). Connect pole #4 or #5 of the Remote Control Demand Switch to the controlled branch circuit (Hot Output). Connect the neutral to pole #9 of the Demand Switch.

**Note: The Demand Switch simply interrupts the hot wire and switches it off and on. This switching is NOT load dependent. It is activated by pressing the button on the Remote Control Clicker, similar to that of an automobile.**

Drill an antenna cable access hole in the panel Box and attach the antenna to the bottom of the Demand Switch. Be sure to comply with local electrical codes.



Attach and mount antenna in an open area.



**Remote Control Demand Switch**  
- Optional 4 Circuit 15 Amp Contactor Connection

